

SYSTEMATIC QUALITY

Cable reels



Catalogue



Standard cable reels

Pages 3 - 6

Full plastic
type 510

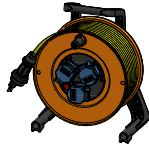

Page 3

Full plastic
type 530



Page 3

Hard rubber
type 501



Page 4

Hard rubber
type 502



Page 5

Hard rubber
type 503

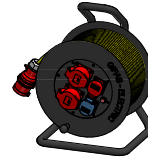

Page 6

Special cable reels

Pages 7 - 10

Steel type 504



Page 7

Steel type 505
(transportable)



Page 8

Steel type 506
(transportable)



Page 9

Cable reel with/
without slip ring



Page 10

Spring-driven cable reels

Pages 11 - 17

Type 520



Page 11

Type 521



Page 12

Type 527



Page 13

Type 523
Type 524



Pages 14 - 15

Type 526



Page 16

Type 525



Page 17

Notes on installation Hose reel for compressed air and cold water

Pages 18 - 23

Notes on
installation



Page 18

Type 583



Page 19

Type 584
(FLEX)



Page 20

Type 584
(SAFE)



Page 21

Type 585
Type 587



Page 22

Type 588



Page 23

Cable reels full plastic type 510, 530

Type 510

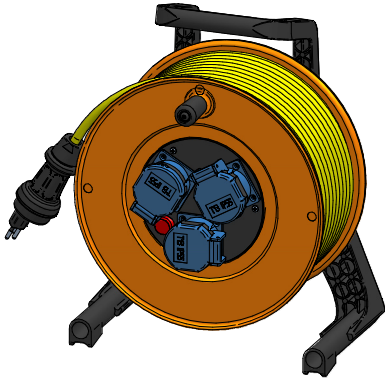

Quality features

- reel body and carry frame made from plastic
- simple, recessed holding brake
- type 13 IP55
- balanced design – low weight
- with thermal protection

Capacity

3×1.5mm²/30m

Weight

approx. 5kg

Dimensions

297×367×208 mm (L×W×H)

Type 510, IP54

	Item no.	Symbol output	Output	Cable length	Cable Ø	Input/plug
✓	244628		3×T13	30m	3×1.5mm ² Gifaflex	T13, vulcanized

Other fitting options on request. All components are available as replacement parts.

Type 530



Quality features

- solid tubular steel frame, black powder-coated, plastic reel body
- simple, recessed holding brake
- type 13 IP55
- balanced design – low weight
- with thermal protection

Capacity

3×1.5mm²

N° art. 246022

20m

N° art. 254701

33m

Weight

ca. 4.4kg



ca. 6.1kg

Dimensions (L×W×H)

235×320×165mm

270×350×200mm

Type 530, IP55

	Item no.	Symbol output	Output	Cable length	Cable Ø	Input/plug
✓	246022		3×T13	20m	3×1.5mm ² H07RN-F	T13, vulcanized
✓	254701		3×T13	33m	3×1.5mm ² H07RN-F	T13, vulcanized

with thermal protection

✓ from stock, offer subject to prior sale

Type 501



Quality features

- solid, halogen-free reel body, fully safety insulated
- solid steel tubular frame, powder-coated in black
- internal wedge brake
- high mechanical strength, resistant to UV and weather conditions
- easy to transport
- maintenance-free, impact-proof and resistant to ageing
- with thermal protection

Capacity

- 3×1 mm²/30m
- 3×1.5 mm²/30m

Weight

- without cable, approx. 3.7kg

Type 501, IP55

Item no.	Symbol output	Output	Cable length	Cable Ø	Input/Plug
✓ 244923		3×T13	30m	3×1 mm ² Gifaflex	T13, vulcanized
✓ 244924		3×T13	25m	3×1.5 mm ² Gifaflex	T13, vulcanized
✓ 244925		3×T23	30m	3×1.5 mm ² Gifaflex	T23, vulcanized

Type 501, IP44

072101		2×CEE 16/3	25m	3×1.5 mm ² Proflex	CEE 16/3, mounted
--------	--	------------	-----	----------------------------------	-------------------

066217 Cable reel type 501, complete, empty (no cable or add-on units)

Other fitting options on request. All components are available as replacement parts.

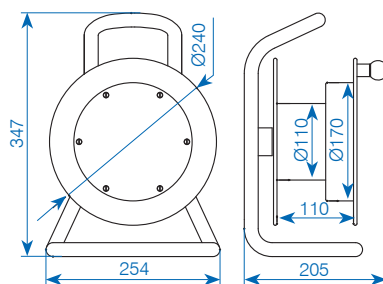

Engraving options for cable reels hard rubber type 501, 502, 503

(Font colour: yellow = standard, white, blue)



Font: SL513 (standard)



Font: Impact (double font)



Logo ➔ Logo mandatory file as dwg or dxf

✓ from stock, offer subject to prior sale

Cable reels hard rubber type 502

Type 502



Quality features

- solid, halogen-free reel body, fully safety insulated
- solid steel tubular frame, powder-coated in black
- internal wedge brake
- high mechanical strength, resistant to UV and weather conditions
- easy to transport
- maintenance-free, impact-proof and resistant to ageing
- with thermal protection

Capacity:

- 3×1.5 mm²/50 m
- 5×1.5 mm²/40 m
- 5×2.5 mm²/33 m

Weight:

- without cable, approx. 4 kg

Type 502, IP55

Item no.	Symbol output	Output	Cable length	Cable Ø	Input/Plug
✓ 244939		3×T13	35 m	3×1.5 mm ² Gifaflex	T13, vulcanized
✓ 244940		3×T13	50 m	3×1.5 mm ² Gifaflex	T13, vulcanized
227788		3×T15	35 m	5×1.5 mm ² Gifaflex	T15, mounted
227789		3×T23	35 m	3×1.5 mm ² Gifaflex	T23, mounted
227790		3×T23	50 m	3×1.5 mm ² Gifaflex	T23, mounted

Type 502, IP44

092885		1×CEE 16/5	30 m	5×1.5 mm ² Gifaflex	CEE 16/5, mounted
092886		2×CEE 16/5	30 m	5×2.5 mm ² Gifaflex	CEE 16/5, mounted
✓ 227766		1×T23 1×T25 2×CEE 16/5	30 m	5×2.5 mm ² Gifaflex	CEE 16/5, mounted

066218 Cable reel type 502, complete, empty (no cable or add-on units)

Other fitting options on request. All components are available as replacement parts.

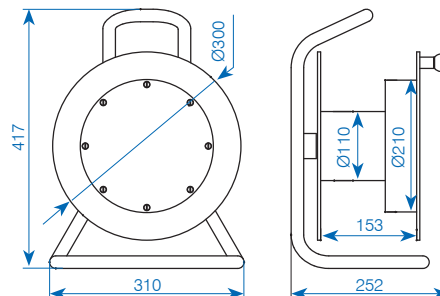

✓ from stock, offer subject to prior sale

Type 503

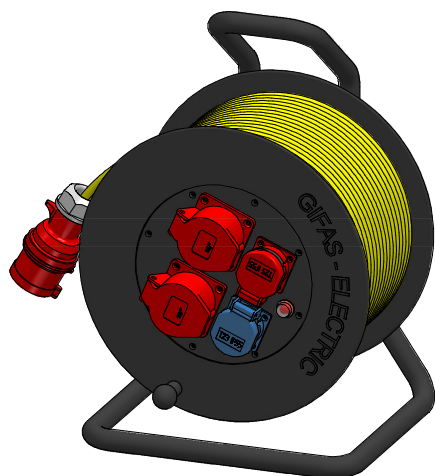

Quality features

- solid, halogen-free reel body, fully safety insulated
- solid steel tubular frame, powder-coated in black
- internal wedge brake
- high mechanical strength, resistant to UV and weather conditions
- easy to transport
- maintenance-free, impact-proof and resistant to ageing
- with thermal protection

Capacity

- 3×1.5mm²/80m
- 5×1.5mm²/70m
- 5×2.5mm²/50m
- 5×4.0mm²/33m
- 5×6.0mm²/25m

Weight

- without cable, approx. 5.5kg

Type 503, IP55

Item no.	Symbol output	Output	Cable length	Cable Ø	Input/Plug
227791		4×T23	70m	3×2.5mm ² Gifaflex	T23, mounted

Type 503, IP44

✓ 227767		1×T23 1×T25 2×CEE 16/5	50m	5×2.5mm ² Gifaflex	CEE 16/5, mounted
✓ 227768		2×T25 2×CEE 16/5	50m	5×2.5mm ² Gifaflex	CEE 16/5, mounted
088496		1×CEE 32/5	30m	5×4mm ² Gifaflex	CEE 32/5, mounted
072121		2×CEE 32/5	30m	5×4mm ² Gifaflex	CEE 32/5, mounted
✓ 072122		2×CEE 32/5	25m	5×6mm ² Gifaflex	CEE 32/5, mounted

065951	Cable reel type 503, complete, empty (no cable or add-on units)				
128059	Cable reel type 503 driveable, galvanized, wheel Ø180mm, empty (no cable or add-on units)				

Other fitting options on request. All components are available as replacement parts.

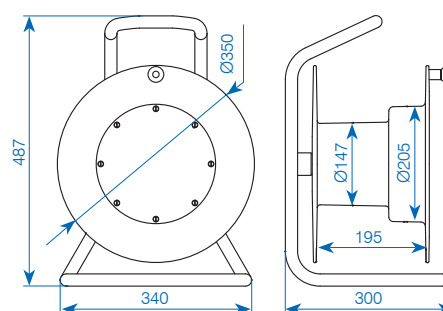

✓ from stock, offer subject to prior sale

Type 504

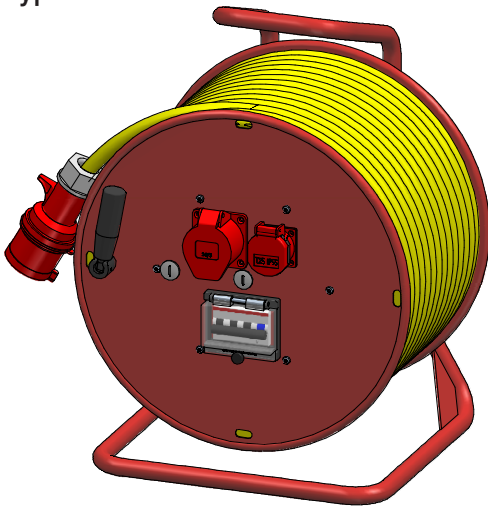

Quality features

- carry frame and reel body made from powder-coated steel
- shaft and inner tube made from A2 stainless steel
- easy to transport
- standard colour «Traffic red» RAL 3020
- tried and tested design – stable construction

Capacity

- 5×2.5mm²/80m
- 5×4mm²/60m
- 5×6mm²/50m
- 5×10mm²/35m

Weight

- without cable, approx. 11 kg



Type 504, IP44

Item no.	Symbol output	Output	Cable length	Cable Ø	Input / Plug
227792		1×T25 1×CEE 16/5 1×FI/LS 4-16A/30mA	50 m	5×4 mm ² Gifaflex	CEE 32/5, mounted
060862		1×CEE 32/5 with thermal protection	50 m	5×4 mm ² Gifaflex	CEE 32/5, mounted
056405		2×CEE 32/5 with thermal protection	40 m	5×6 mm ² Gifaflex	CEE 32/5, mounted
✓ 056407		2×CEE 32/5 with thermal protection	50 m	5×6 mm ² Gifaflex	CEE 32/5, mounted

Type 504, IP44

056424		1×CEE 63/5	35 m	5×10 mm ² Proflex	CEE 63/5, mounted
--------	--	------------	------	---------------------------------	----------------------

✓ 072050 Transport trolley, black powder-coated, with two full rubber tyres Ø200mm

Other fitting options on request. All components are available as replacement parts.

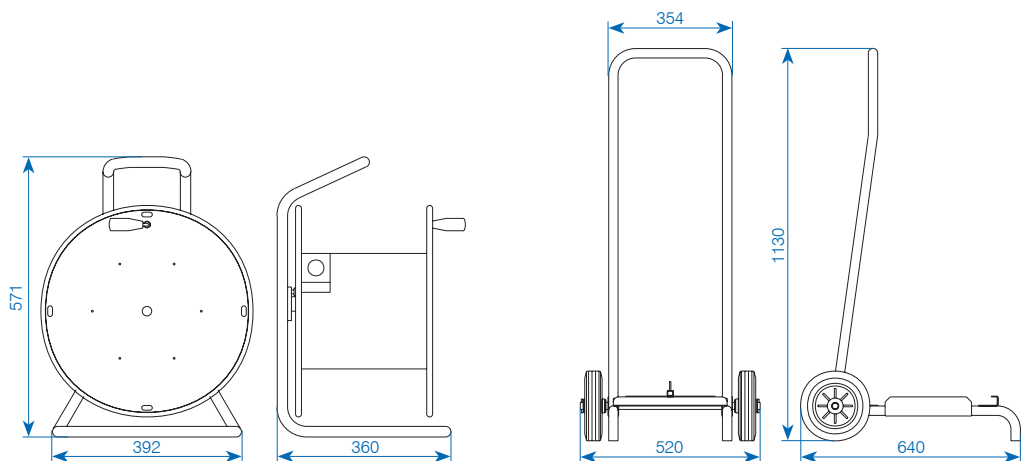

✓ from stock, offer subject to prior sale

Type 505

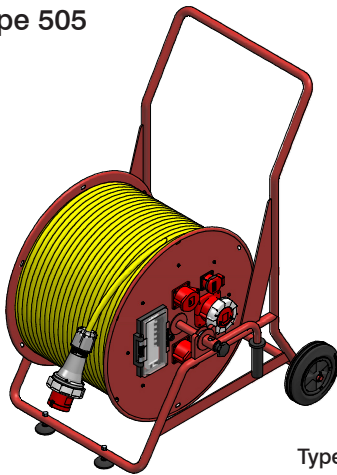

Quality features

- standard colour «Traffic red» RAL 3020
- stable chassis made from steel tubing
- bearing-mounted reel body made from steel plate
- carry handles on both sides, can also be used as a crank, insulated handle
- low centre of gravity
- large solid rubber wheels

Capacity

- 5×6mm²/100m
- 5×10mm²/80m
- 5×16mm²/60m

Weight

- without cable, approx. 24 kg

Type 505, IP44

Item no.	Symbol output	Output	Cable length	Cable Ø	Input / Plug
092888		1×CEE 32/5 with thermal protection	80m	5×6mm ² Gifaflex	CEE 32/5, mounted
056408		2×CEE 32/5 with thermal protection	80m	5×6mm ² Gifaflex	CEE 32/5, mounted
056414		1×CEE 32/5 1×CEE 63/5 1×FI/LS 4-32A/30mA 1×LS 3-63A 10kA	80m	5×10mm ² Proflex	CEE 63/5, mounted



Type 505, IP55

056415		1×CEE 63/5 1×LS 3-63A 10kA	60m	5×10mm ² Proflex	CEE 63/5, mounted
056417		1×CEE 63/5 1×LS 3-63A 10kA	80m	5×10mm ² Proflex	CEE 63/5, mounted
056418		1×CEE 63/5 1×LS 3-63A 10kA	50m	5×16mm ² Proflex	CEE 63/5, mounted
056419		1×CEE 63/5 1×LS 3-63A 10kA	60m	5×16mm ² Proflex	CEE 63/5, mounted
018496	Reel body with carry handles for type 505, red, no chassis				
220860	Reel body sheet steel red type 505, with carrying handles and chassis, 1 cut-out for CEE 63/5, max. capacity 100 m 5×10 mm ²				



Type 505, IP44, FI+LS

227794		1×T25 1×CEE 16/5 1×CEE 32/5 1×CEE 63/5 1×FI 4-63A/30mA 1×FI 3-16A/30mA 1×FI 3-32A/30mA	50m	5×10mm ² Proflex	CEE 63/5, mounted
--------	--	--	-----	-----------------------------	-------------------

Other fitting options on request. All components are available as replacement parts.

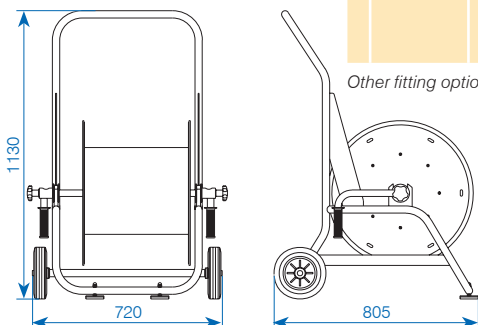

Cable reels steel type 506 (transportable)

Type 506



Quality features

- standard colour «Traffic red» RAL 3020
- stable chassis made from steel tubing
- bearing-mounted reel body made from steel plate
- carry handles on both sides, can also be used as a crank, insulated handle
- low centre of gravity
- large solid rubber wheels

Type 506, IP55

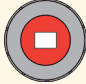
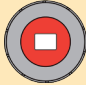
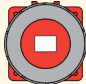
Item no.	Symbol output	Output	Cable length	Cable Ø	Input/Plug	Stable chassis
156354		Connector 1×CEE 125/5	50 m	5×25 mm ² Euroflex	CEE 125/5	4 rolls
114369		Connector 1×CEE 125/5	45 m	5×35 mm ² EPR/PUR	CEE 125/5	4 rolls
136938		1×CEE 125/5	50 m	5×35 mm ² EPR/PUR	CEE 125/5	4 rolls

Other fitting options on request.

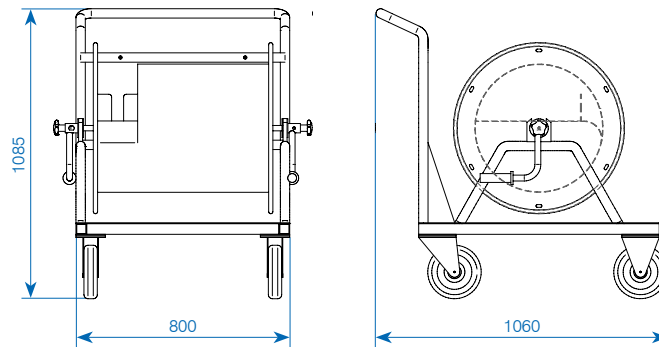

Type 515 with slip ring



Quality features

- with slip ring
- solid steel tubular frame, powder-coated in black
- high mechanical strength
- easy to transport
- with thermal protection

Capacity

- 3×1.5mm²/50m
- 5×1.5mm²/35m

Weight

- without cable, approx. 3.8kg

Type 518, IP55

Item no.	Slip ring	Output	Cable length	Cable Ø	Input/plug
227795	3-pole 16A	T13 coupling	35m/3m	3×1.5mm ² Gifaflex	T12, mounted
227796	3-pole 16A	T13 coupling	50m/3m	3×1.5mm ² Gifaflex	T12, mounted

✓ 187537	3-pole 16A				empty, no cable
----------	------------	--	--	--	-----------------

Type 518 with secondary reel (without slip ring)



Quality features

- solid, halogen-free hard rubber reel body
- solid, steel frame blue
- external, maintenance-free holding brake
- impact-proof and resistant to ageing
- high mechanical strength
- resistant to chemical influences
- UV and weather-resistant
- high quality, tested accessory components
- with thermal protection

Capacity

- 3×1.5mm²/90m
- 5×2.5mm²/40m

Weight

- without cable, approx. 7.5kg

Type 518, IP55

Item no.	Main reel	Secondary reel	Version
227893	55m/3×1.5mm ² coupling T13	5m/3×1.5mm ² T13 plug	Gifaflex secondary reel moves at same time

Type 518, IP44

028495	35m/5×2.5mm ² coupling CEE 16/5	5m/5×2.5mm ² CEE 16/5 plug	Proflex secondary reel moves at same time
--------	---	--	---

Other fitting options on request.

Type 515

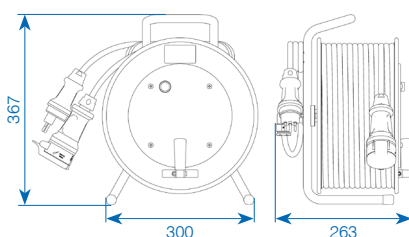

Type 518

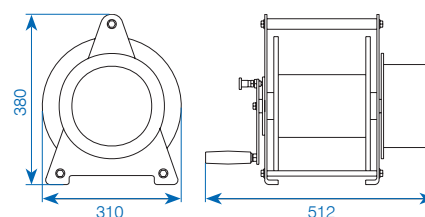

✓ from stock, offer subject to prior sale

Spring-driven cable reels type 520

Type 520 (9000)



Quality features

- fully assembled spring-driven cable reel, with swivel wall bracket
- casing made from impact-proof plastic black/yellow
- retraction lock with toothed lock every 50cm, easy to switch off
- with thermal protection
- cut lengths 5 to 7 m
- slip ring 2- to 3-pole
- max. operating voltage 230V
- protection category IP42
- standard: IEC1242

Notes on installation

Suitable for:

- wall mounting
- floor mounting (reel body fixed with bracket)
- ceiling mounting (reel body fixed with bracket)

Illustration of installation options: see page 18.

Item no.	No. of poles	Cross-section	Cable length, rolled up	Output rolled up	Output unreeled
✓ 058047	3	1.0 mm ²	6 m + 1.0 m free	1'100W	1'600W
✓ 058049	3	1.5 mm ²	5 m + 1.0 m free	1'400W	1'900W

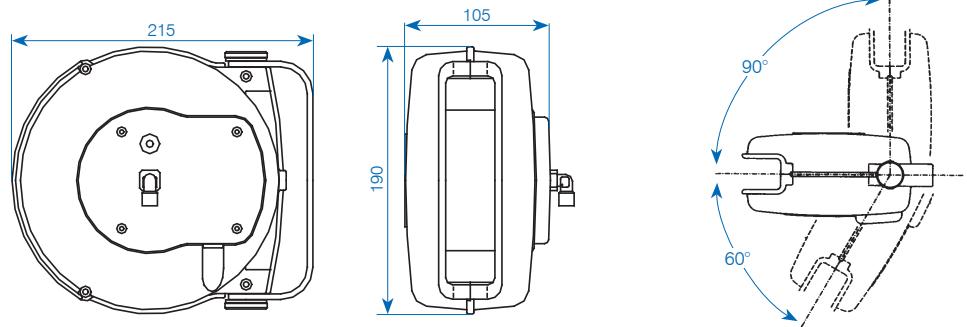

✓ from stock, offer subject to prior sale

Type 521 (XF)

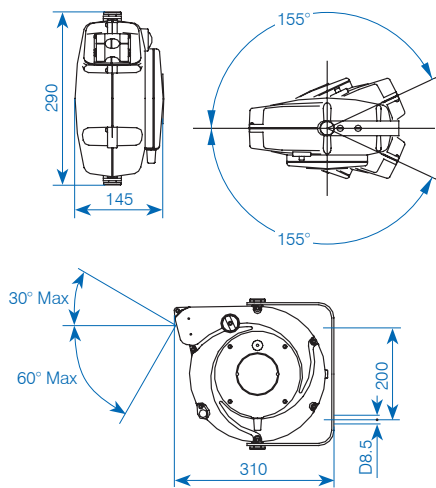

Quality features

- fully assembled and preset push cable reel, with swivel wall bracket
- encased casing made from impact-proof yellow plastic
- retraction lock with toothed lock every 50cm, easy to switch off
- with thermal protection, 2- to 3-pole
- special cable, black (end cut to a smooth finish, no connection coupling)
- cut lengths 3 to 14 m
- slip ring 1- to 8-pole 10A, also 20A possible
- max. operating voltage 500V
- protection category IP42/with cover cap = IP43
- standard: IEC1242
- strands colour from 7-pole version: black

Notes on installation

Suitable for:

- wall mounting
- floor mounting (reel body fixed with bracket)
- ceiling mounting (reel body fixed with bracket)

Illustration of installation options: see page 18.

Thermal protection

The design with thermal protection is only possible for 230 V. A link must be fitted between the terminals.

With 4- or 5-pole connections, the thermal protection can only be used via an external isolating switch (contactor). A 6- or 7-pole supply lead is required for this, however.

Accessories

To reduce the amount of contamination entering through the cable inlet, there is a cover cap available as an accessory (protective bellow). This can be retrofitted and increases the protection rating to IP43.

Item no.	No. of poles	Cross-section	Cable length, rolled up	Performance, rolled up	Performance, unreeled	Thermal protection
✓ 037942	1	6.0mm ²	12.5m + 1.5m free			no
039732	1	16.0mm ²	8.5m + 1.5m free			no
✓ 050984 ¹	2	1.0mm ²	14.0m + 1.5m free	900W	1'400W	yes
✓ 035034	3	1.0mm ²	12.5m + 1.5m free	900W	1'400W	yes
✓ 035063	3	1.5mm ²	10.0m + 1.5m free	1'200W	1'800W	yes
040385*	3	2.5mm ²	7m+1.5m free	1'900W	2'500W	yes
045221	4	1.5mm ²	8.0m + 1.5m free	1'400W	1'900W	no
036871	5	1.0mm ²	7.5m + 1.5m free	1'000W	1'500W	no
✓ 035182	5	1.5mm ²	5.5m + 1.5m free	1'400W	1'900W	no
041457	7	1.0mm ²	6.0m + 1.5m free			no

¹ higher degree of protection IP55 available

* reinforced collector ring 20A

Other versions available on request. Increased protection rating IP55 available.

Various types also available with reinforced cable (H07RN-F), operating voltage 750V.

Please ask us.

Accessories/spare parts	
✓ 044663	Cover cap

✓ from stock, offer subject to prior sale

Spring-driven cable reels type 527 (AL)

Type 527 (AL)



Quality features

- housing made of die-cast aluminium, painted in black
 - retraction lock with toothed lock every 50cm, easy to switch off
 - cut lengths 12 to 27m*
 - double ground contact
 - collector with brass rings and special brushes with very low voltage drop
 - slip ring insulation voltage 2.5kV
 - max. operating voltage 500V
 - ambient temperature -5°C / +50°C
 - without cable on the supply side
 - protection category IP42
 - optional with SAFETY-Return
- *smaller version (without SAFETY-Return) available on request

Notes on installation

Suitable for:

- wall mounting
- floor mounting (reel body fixed with bracket)
- ceiling mounting (reel body fixed with bracket)

Illustration of installation options: see page 18.

Item no.	No. of poles	Cross-section	Cable length, rolled up	Performance, rolled up	Performance, unreeled
✓ 250575	3	1.5mm ²	20m + 2.0m free	1'100W	1'800W
✓ 250576	3	2.5mm ²	17m + 2.0m free	2'000W	3'000W
✓ 250577	5	1.5mm ²	15m + 2.0m free	1'500W	2'200W
✓ 250578	5	2.5mm ²	10m + 2.0m free	2'000W	3'000W

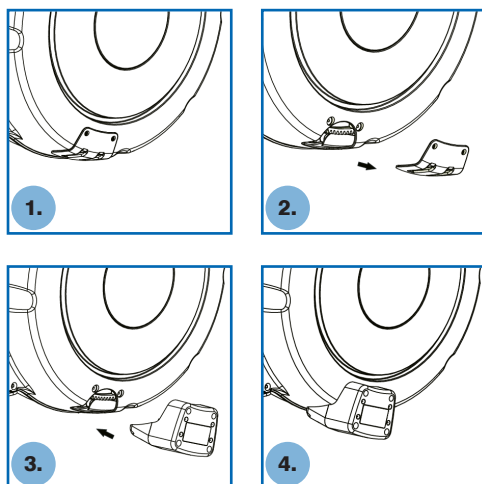

SAFETY-Return

The SAFETY-Return enables the cable to be rewound slowly, thus avoiding dangerous kickbacks if the cable slips out of the operator's hand.



item no. 250667

Accessories/spare parts	
✓ 026118	Locking set for spring-driven cable reel for ceiling mounting (fixed installation)
✓ 250667	Backstop SAFETY-Return

✓ from stock, offer subject to prior sale

Type 523 (4000)

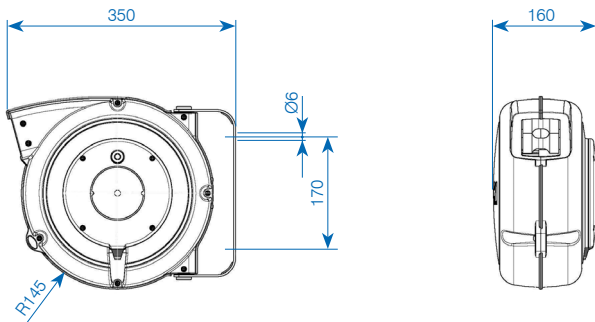

Quality features

- fully assembled and preset push cable reel, with swivel wall bracket
- enclosed casing made from impact-proof yellow plastic
- retraction lock with toothed lock every 50 cm, easy to switch off
- terminal board on supply side
- reinforced slip ring package for increased requirements with double earthing contacts
- with thermal protection
- cut lengths 8 to 17 m
- slip ring 1- to 5-pole 10A
- max. operating voltage 500V
- protection category IP40
- standard: IEC1242

Notes on installation

Suitable for:

- wall mounting
- floor mounting (reel body fixed with bracket)
- ceiling mounting (reel body fixed with bracket)

Illustration of installation options: see page 18.

Thermal protection

The design with thermal protection is only possible for 230V. A link must be fitted between the terminals.

With 4- or 5-pole connectionst the thermal protection can only be used via an external isolating switch (conactor). A 6- or 7-pole supply lead is required for this, however.

Item no.	No. of poles	Cross-section	Cable length, rolled up	Performance, rolled up	Performance, unreeled	Thermal protection
✓ 021016	1	6.0 mm ²	15 m + 1.0 m free			no
✓ 021020	3	1.5 mm ²	14 m + 1.0 m free	1'200 W	1'800 W	yes
✓ 021021	3	2.5 mm ²	9 m + 1.0 m free	1'900 W	2'500 W	yes
✓ 021023	5	1.5 mm ²	8 m + 1.0 m free	1'400 W	1'900 W	no

Other versions available on request. Various types also available with reinforced cable (H07RN-F), operating voltage 750V. Please ask us.

Item no.	No. of poles	Cross-section	Cable length, rolled up	Remark
192566	(4×(2×))	0.15 mm ²	11 m + 1.0 m free	Ethernet-Network (CAT 6)

Accessories / spare parts

- ✓ 024246 Locking device for ceiling mounting (fixed installation)

✓ from stock, offer subject to prior sale

Spring-driven cable reels type 524

Type 524 (7000)

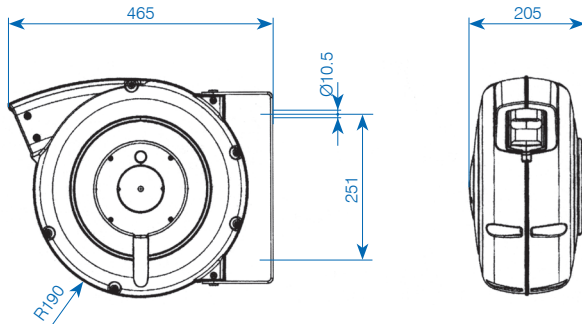

Quality features

- fully assembled and preset push cable reel, with swivel wall bracket
- enclosed casing made from impact-proof grey plastic
- drawback spring of special steel, appointed at delivery on continuous load, detent adjustable
- terminal board on supply side
- reinforced slip ring package for increased requirements
- double ground contact
- cut lengths 15 to 25 m
- slip ring 1- to 5-pole 10A
- max. operating protection 500V
- protection category IP42
- standard: IEC1242
- optional with SAFETY-Return

Notes on installation

Suitable for:

- wall mounting
- floor mounting (reel body fixed with bracket)
- ceiling mounting (reel body fixed with bracket)

Illustration of installation options: see page 18.

Item no.	No. of poles	Cross-section	Cable length, rolled up	Performance, rolled up	Thermal protection
021024	1	16.0mm ²	20m + 2.0m free		
✓ 021026	3	1.5mm ²	25m + 2.0m free	1'100W	1'800W
✓ 021027	3	2.5mm ²	20m + 2.0m free	2'000W	3'000W
✓ 021030	5	1.5mm ²	20m + 2.0m free	1'500W	2'200W
✓ 021031	5	2.5mm ²	15m + 2.0m free	2'000W	3'000W

Other versions available on request. Various types also available with reinforced cable (H07RN-F), operating voltage 750V. Please ask us.

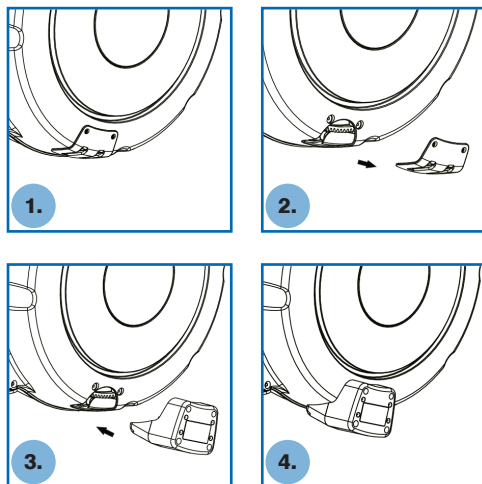

SAFETY-Return

The SAFETY-Return enables the cable to be rewound slowly, thus avoiding dangerous kickbacks if the cable slips out of the operator's hand.



item no. 211865

Accessories/spare parts	
✓ 026118	Locking set for spring-driven cable reel for ceiling mounting (fixed installation)
✓ 211865	Backstop SAFETY-Return

✓ from stock, offer subject to prior sale

Type 526 (1400)

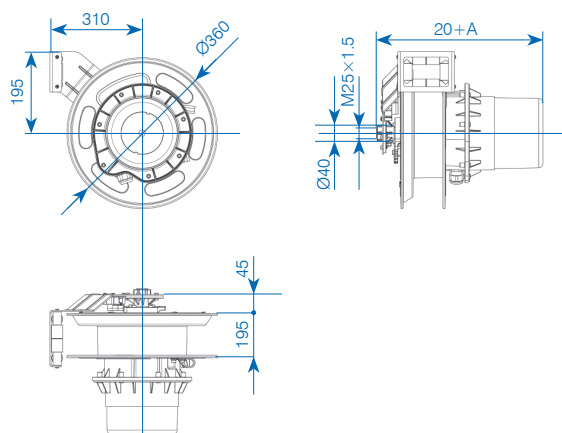

Quality features

- fully assembled and preset spring-driven cable reel (holder not included, must be ordered separately).
- robust, open design, suitable for industrial use, in aluminium/steel, epoxy-coated, cable inlet of aluminium
- direct fitting on to the wall or with special swivelling holder
- with special spring drive unit, spring made from special steel with high resistance capacity
- collectors with 20, 50 and 100A
- cut lengths up to max. 20m
- slip ring 1- to 12-pole possible
- max. operating voltage 400V
- protection category IP65
- tested to EN 61242, EN 61316
- strands colour from 8-pole version: black
- cable H05 VV-F black

Notes on installation

Suitable for:

- wall mounting
- floor mounting (item no. 137845 necessary)
- ceiling mounting (item no. 137845 necessary)

Illustration of installation options: see page 18.

The spring-driven cable reels are supplied with continuous retraction setting ex works. Please inform while ordering if the lock device should be changed.

Item no.	No. of poles	Cross-section	Cable length, rolled up	Performance, rolled up	Thermal protection	Max load on slip ring	Dimension specifications (diagram below)		
							A	B	C
✓ 146614	3	2.5mm ²	20m + 2m free	2'000W	3'500W	20A	360mm	105mm	350mm
✓ 146617	5	2.5mm ²	15m + 2m free	7'000W	10'000W	50A	360mm	105mm	350mm
✓ 140217	5	4.0mm ²	8m + 2m free	11'000W	15'000W	50A	360mm	105mm	350mm



Item no. 137845



Item no. 139016

Example ceiling mounting

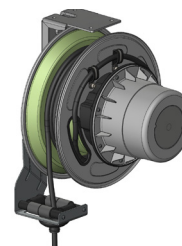
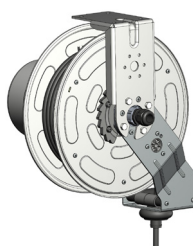

Accessories/spare parts	
✓ 137845	Wall/ceiling/floor holder for fixed mounting
✓ 139016	Wall holder, swivelling

Spring-driven cable reels type 525

Type 525 (1700)

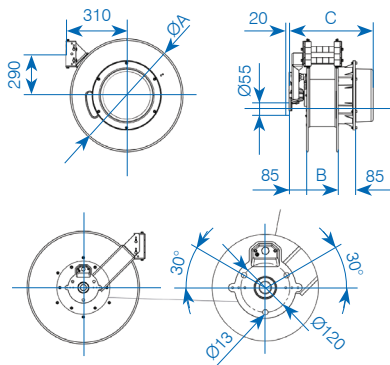

Quality features

- fully assembled and preset spring-driven cable reel
- robust, open design, suitable for industrial use, in aluminium/steel, epoxy-coated
- direct fitting on to the wall or with special swivelling holder
- with special spring drive unit, spring made from special steel with high resistance capacity
- slip ring 1- to 25-pole possible
- max. operating voltage 500V
- protection category IP65
- tested to EN 61242, EN 61316
- strands colour from 7-pole version: black
- optionally with SAFETY-Return

Notes on installation

Suitable for:

- wall mounting
- floor mounting (item no. 016123 necessary)
- ceiling mounting (item no. 016123 necessary)

Illustration of installation options: see page 18.

The spring-driven cable reels are supplied with continuous retraction setting ex works. The lock device can be easily switched on before commissioning.

Supplied complete with approx. 2.5 m connection wire on the mains input and 2 m external cable (special cable, black, end cut off smoothly, no connection coupling) in H05VV F quality. Different types are available with reinforced cables (H07RN-F).

Item no.	No. of poles	Cross-section	Cable length, rolled up	Performance, rolled up	Thermal protection	Max load on slip ring	Dimension specifications (diagram below)		
							A	B	C
059712 ¹⁾	1	16.0mm ²	30m + 2m free			60.0A	440mm	160mm	365mm
059714	3	2.5mm ²	29m + 2m free	2'000W	3'500W	32.0A	440mm	160mm	365mm
✓ 014192	5	2.5mm ²	20m + 2m free	7'000W	9'500W	32.0A	440mm	160mm	365mm
✓ 059715	5	2.5mm ²	24m + 2m free	7'000W	9'500W	32.0A	440mm	160mm	365mm
013362	5	6.0mm ²	15m + 2m free	17'000W	22'000W	60.0A	440mm	160mm	410mm
✓ 198346 ²⁾	5	6.0mm ²	15m + 2m free	17'000W	22'000W	60.0A	440mm	160mm	410mm

¹⁾ ceiling mounting not possible

²⁾ SAFETY-Return included

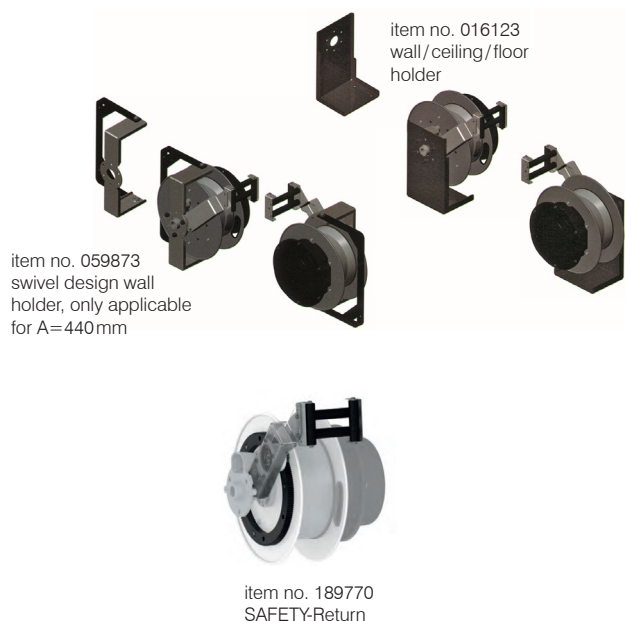

Accessories / spare parts	
✓ 059873	Wall holder, swivelling (only for flange-Ø440mm)
✓ 016123	Wall / ceiling / floor holder
✓ 016871	Connection nipple M25, black
✓ 016872	Reduction screw M32-M25
✓ 038208	Plastic cable protective tube, black, flexible
189770*	Backstop SAFETY-Return

*can only be fitted during the manufacture of the cable reel, please specify when ordering!

✓ from stock, offer subject to prior sale

Wall mounting

- cable reel mounted on the wall
- swivelling
- fixation of the reel body in the mounting bracket not necessary

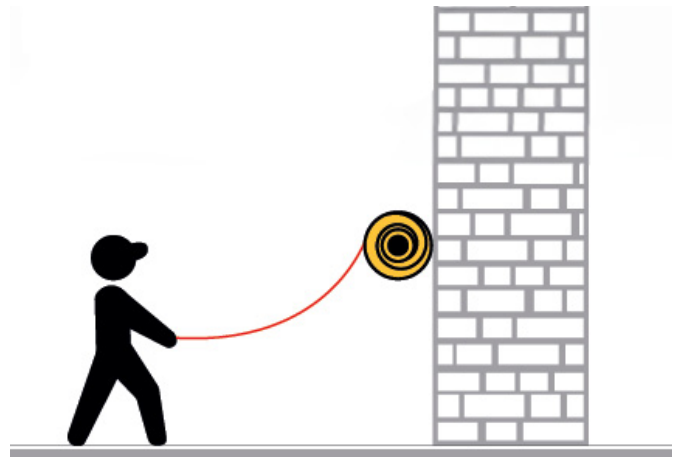

Floor mounting

- cable reel mounted at the bottom
- for installation with increased cable length and the associated higher weight of the cable
- fixation of the reel body in the mounting bracket necessary

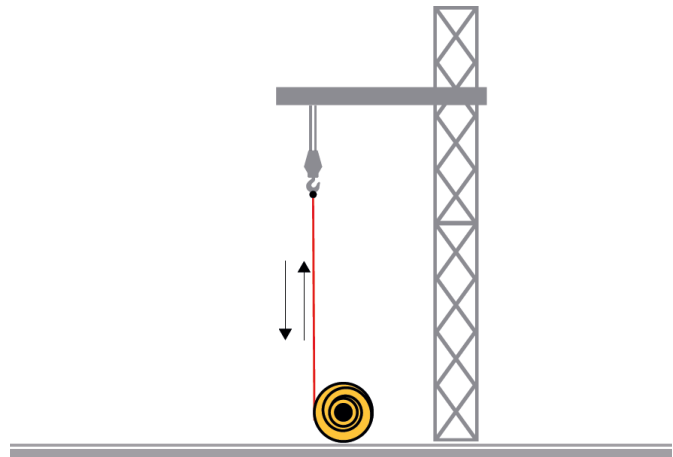

Ceiling mounting

- cable reel mounted at the top
- for installation with a reduced number of metres of cable and the associated lower weight
- fixation of the reel body in the mounting bracket necessary

For ceiling mounting and thus a vertical cable outlet / pull-up, the roller body is fixed in the mounting bracket. Please specify when ordering.

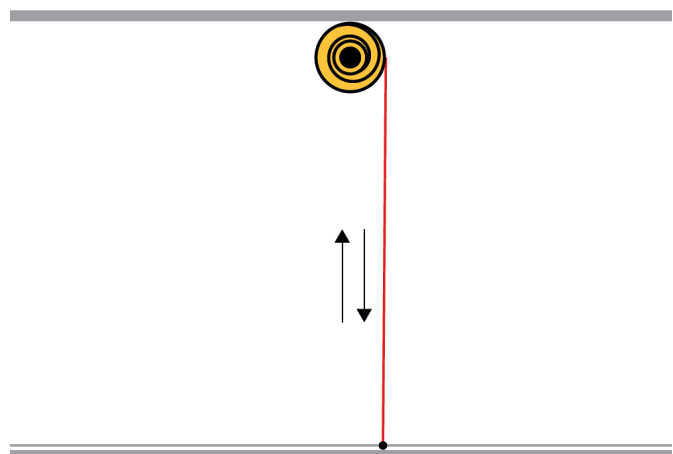
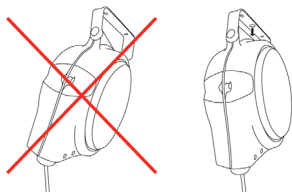

Notice

If the length and cross-section increase, the dead weight of the cable increases. This limits the installation options of the cable reel.

Hose reel for air and water type 583

Type 583 (804)



Quality features

- KPU hose
- technopolymer structure
- swivelling metal bracket for wall or ceiling mounting
- housing made of impact-resistant plastic
- operating pressure max. 15 bar

Notes on installation

Suitable for:

- wall mounting
- floor mounting (reel body fixed with bracket)
- ceiling mounting (reel body fixed with bracket)

Illustration of installation options: see page 18.

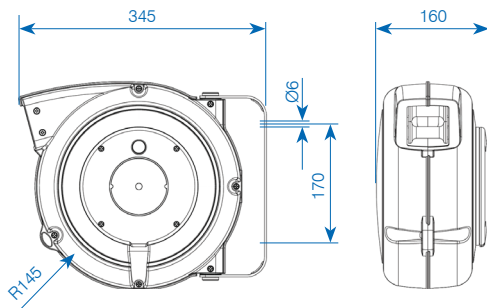

Item no.	Hose length rolled-up	Internal-Ø	Connection	Pressure	Colour
✓ 052496	9 m + 1 m free	8.0 mm	1/4"	15 bar	yellow

Accessories/spare parts

- ✓ 024246 Locking device for ceiling mounting (fixed installation)

✓ from stock, offer subject to prior sale

Type 584 (FLEX)

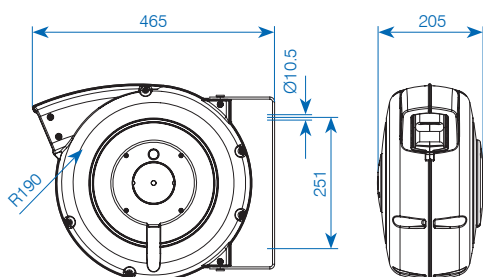

Quality features

- hose reel for air and cold water
- with drawback spring
- housing made of impact-resistant blue plastic (also available in yellow on request)
- reel set at factory with locking device, can be switched to continuous pull
- operating pressure max. 15 bar
- FLEX hose, very flexible, antistatic, does not attract dust and paint particles
- optional with SAFETY-Return

Notes on installation

Suitable for:

- wall mounting
- floor mounting (reel body fixed with bracket)
- ceiling mounting (reel body fixed with bracket)

Illustration of installation options: see page 18.

Item no.	Hose length rolled-up	Internal-Ø	Connection	Pressure	Colour
✓ 250507	15 m + 1.5 m free	8 mm	1/4"	15 bar	blue
✓ 250508	15 m + 1.5 m free	10 mm	3/4"	15 bar	blue

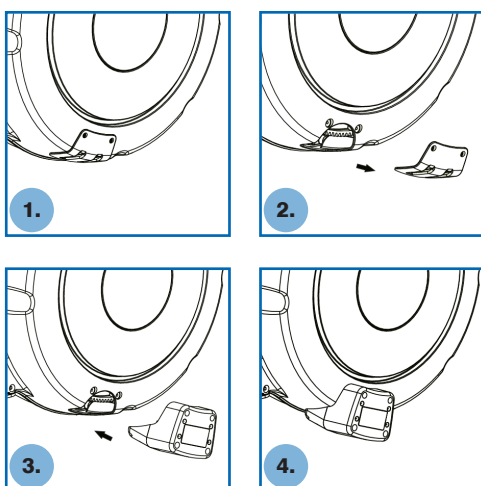

SAFETY-Return

The SAFETY-Return enables the hose to be rewound slowly, thus avoiding dangerous kickbacks if the hose slips out of the operator's hand.



item no. 250666

Accessories / spare parts	
✓ 026118	Locking set for spring-driven cable reel for ceiling mounting (fixed installation)
✓ 250666	Backstop SAFETY-Return

Hose reel for air and water type 584 (SAFE)

Type 584 (SAFE)



Quality features

- hose reel for air and cold water
- with drawback spring
- housing made of impact-resistant black plastic
- reel set at factory with locking device, can be switched to continuous pull
- operating pressure max. 15 bar
- lime green KPU hose, highly visible, reduces the risk of tripping
- optional mit SAFETY-Return

Notes on installation

Suitable for:

- wall mounting
- floor mounting (reel body fixed with bracket)
- ceiling mounting (reel body fixed with bracket)

Illustration of installation options: see page 18.

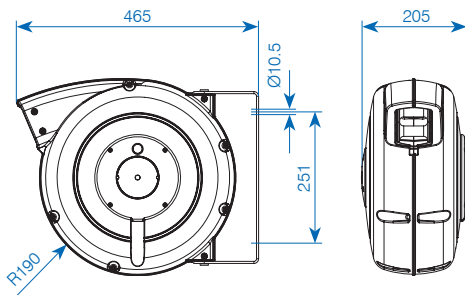

Item no.	Hose length rolled-up	Internal-Ø	Connection	Pressure	Colour
✓ 250509	16m + 1.5m free	8mm	1/4"	15 bar	black
✓ 250510	16m + 1.5m free	10mm	3/4"	15 bar	black

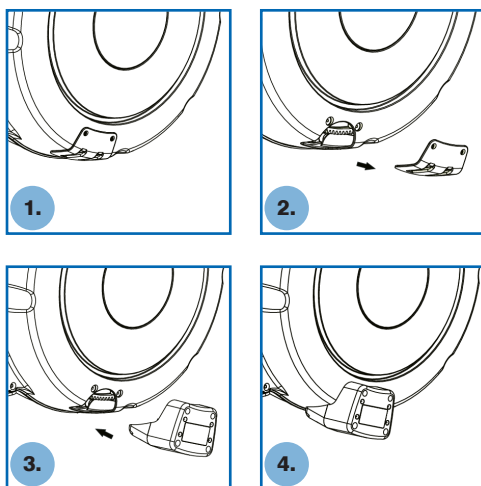

SAFETY-Return

The SAFETY-Return enables the hose to be rewound slowly, thus avoiding dangerous kickbacks if the hose slips out of the operator's hand.



item no. 250666

Accessories/spare parts	
✓ 026118	Locking set for spring-driven cable reel for ceiling mounting (fixed installation)
✓ 250666	Backstop SAFETY-Return

✓ from stock, offer subject to prior sale

Type 585 (813)

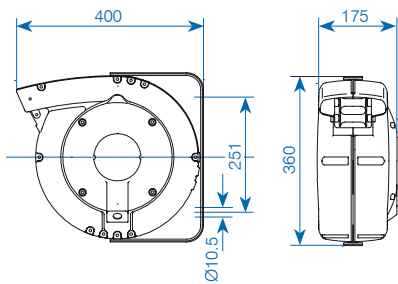

Quality features

- hose reel for air and cold water
- model with improved performance, closed design
- housing made of die-cast aluminium, stove-enamelled yellow
- reel set at factory with locking device, can be switched to continuous pull
- operating pressure max. 12 bar
- polyurethane hose
- swivelling bracket for wall or ceiling mounting

Notes on installation

Suitable for:

- wall mounting
- floor mounting (reel body fixed with bracket)
- ceiling mounting (reel body fixed with bracket)

Illustration of installation options: see page 18.

Item no.	Hose length rolled-up	Internal-Ø	Connection	Pressure
✓ 039797	10m + 2m free	8mm	1/4"	12 bar

Type 587 (8800)

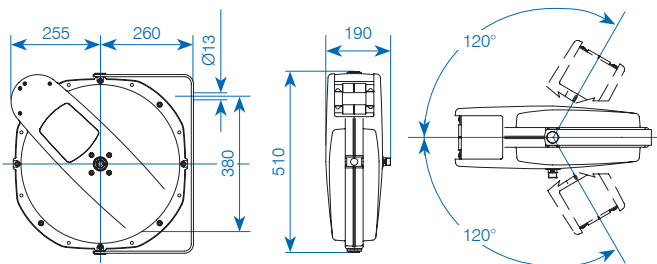

Quality features

- hose reel for air and cold water
- closed design with high pressure resistance of 20 bar
- solid aluminium pressure housing, powder-coated, yellow
- stop device for desired hose length
- brass / stainless steel straight-through joint
- inlet connection on straight-through joint
- polyurethane hose
- swivelling bracket for wall or ceiling mounting

Notes on installation

Suitable for:

- wall mounting
- floor mounting (reel body fixed with bracket)
- ceiling mounting (reel body fixed with bracket)

Illustration of installation options: see page 18.

Item no.	Hose length rolled-up	Internal-Ø	Connection	Pressure
✓ 059284	15m + 1m free	12.5mm	1/2"	20 bar

✓ from stock, offer subject to prior sale

Hose reel for air and water type 588

Type 588 (8400)



Quality features

- hose reel for air and cold water
- large model, can be fitted in different ways, open layout
- reel body made from high quality special plastic
- shiny polyurethane hose
- max. operating pressure 20 bar
- supporting yoke made from zinc-plated, stainless steel
- stop device for hose length required
- through-joint in brass/stainless steel
- intel connection on the through-joint
- universal hose locking piece
- swivel-motion with add-on unit

Item no.	Hose length rolled-up	Internal-Ø	Connection	Pressure
153268	15 m	12.5 mm	1/2"	20 bar
153269	20 m	12.5 mm	1/2"	20 bar

Assembly options

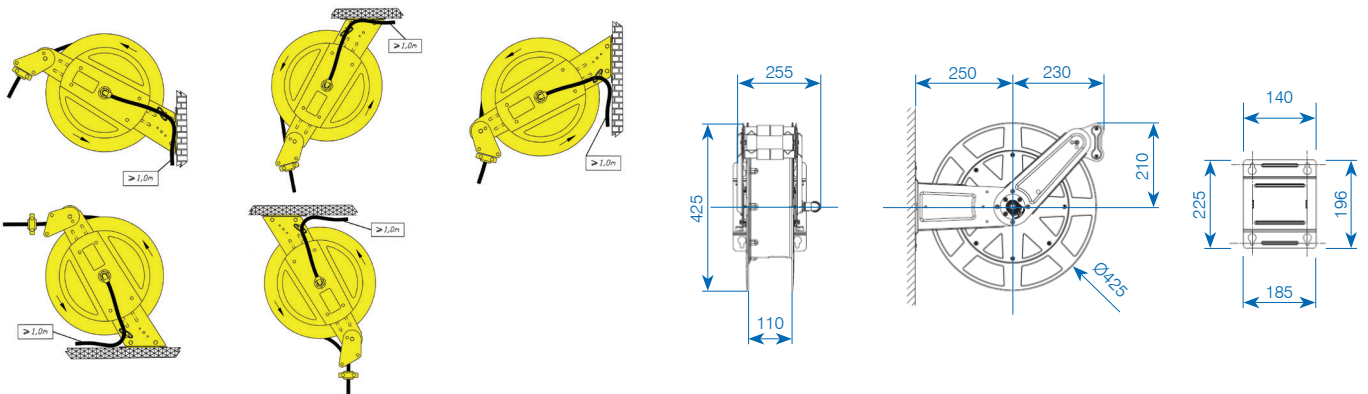

The appropriate unit is required for the swivel-motion version:

Item no.	Description
153270	Swivel bracket for type 588
153271	Coil cover yellow for type 588
153272	Coil cover black for type 588

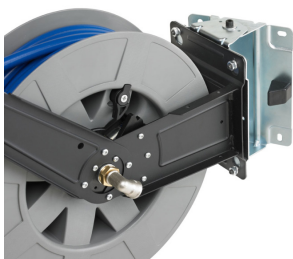

item no. 153270

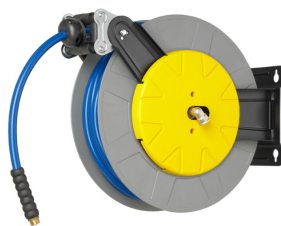

item no. 153271

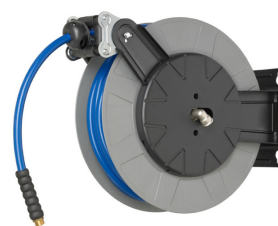

item no. 153272

GET IN TOUCH WITH US

News about the assortment and specific solutions can be found on our website:

www.gifas.ch

We reserve the right to make technical modifications. V 0624

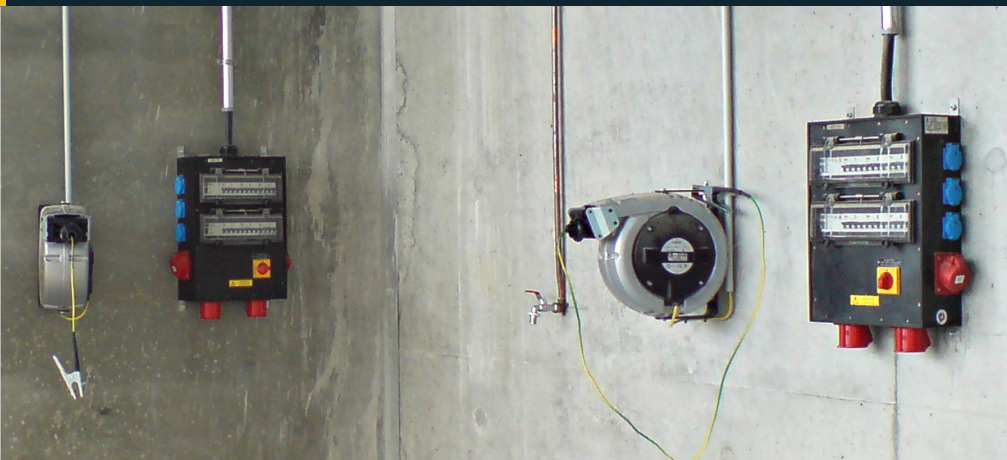

GIFAS
ELECTRIC

GIFAS-ELECTRIC GmbH
Dietrichstrasse 2
CH-9424 Rheineck

+41 71 886 44 44
+41 71 886 44 49
info@gifas.ch
www.gifas.ch